

# Insulated and Non-Insulated Ring Terminals

## Vinyl-Insulated Large Ring Terminals

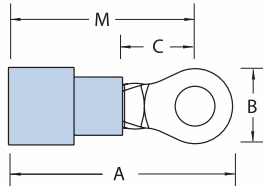

Sta-Kon Terminal Products and Tools



CAT. NO.	WIRE RANGE	MAX. INS.	BOLT HOLE	REC. TOOL	DIMENSIONS				STOCK THICK.	
					A	B	C	M		
RDV167	8	.340	#8	ERG2007	1.48	.42	.28	1.17	.04	
RDV367	8	.340	#10		1.48	.42	.28	1.17		
RDV717	8	.340	1/4"		1.54	.46	.36	1.20		
RDV727	8	.340	5/16"		1.63	.57	.36	1.23		
RDV737	8	.340	3/8"	TBM6S	1.63	.57	.36	1.23		
RDV757*	8	.310	1/2"		1.79	.82	.55	1.27		
REV267	6	.420	#10	ERG2007	1.65	.45	.28	1.23		
REV717	6	.420	1/4"		1.65	.49	.28	1.23		
REV727	6	.420	5/16"		1.76	.61	.34	1.30		
REV737	6	.420	3/8"		1.76	.61	.34	1.30		
REV757*	6	.395	1/2"		TBM6S	1.83	.82	.55		1.26

\*Brazed Seam

Constructed of electrolytic copper for high conductivity!

## Non-Insulated Ring

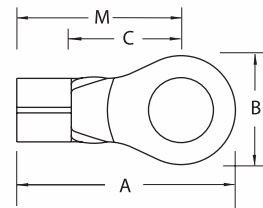

CAT. NO.	PKG. QTY.	WIRE RANGE	BOLT HOLE	REC. TOOL	DIMENSIONS				STOCK THICK.
					A	B	C	M	
A18-4	100	22-16	#4	ERG2002	.75	.31	.27	.59	.03
A18-6	100	22-16	#6		.72	.25	.27	.59	
A85	1,000	22-16	#6		.72	.25	.27	.59	
A18-8	100	22-16	#8		.75	.31	.27	.59	
A86	1,000	22-16	#8		.75	.31	.27	.59	
A18-10	100	22-16	#10		.75	.31	.27	.59	
A87	1,000	22-16	#10		.75	.31	.27	.59	
A18-14	100	22-16	1/4"		.92	.50	.37	.67	
A71	1,000	22-16	1/4"		.92	.50	.37	.67	
A18-516	100	22-16	5/16"		.92	.50	.37	.67	
A72	1,000	22-16	5/16"		.92	.50	.37	.67	
A18-38	100	22-16	3/8"		.99	.54	.35	.67	
A73	1,000	22-16	3/8"		.99	.54	.35	.67	
A18-12	100	22-16	1/2"		1.06	.72	.38	.70	
A75	1,000	22-16	1/2"		1.06	.72	.38	.70	
B14-4	100	18-14	#4		.72	.25	.27	.59	
B132	1,000	18-14	#4		.72	.25	.27	.59	
B14-6	100	18-14	#6		.72	.25	.27	.59	
B133	1,000	18-14	#6	.72	.25	.27	.59		
B14-8	100	18-14	#8	.75	.31	.27	.59		
B86	1,000	18-14	#8	.75	.31	.27	.59		
B14-10	100	18-14	#10	.75	.31	.27	.59		
B87	1,000	18-14	#10	.75	.31	.27	.59		
B14-14	100	18-14	1/4"	.93	.50	.38	.68		

CAT. NO.	PKG. QTY.	WIRE RANGE	BOLT HOLE	REC. TOOL	DIMENSIONS				STOCK THICK.
					A	B	C	M	
B71	1,000	18-14	1/4"	ERG2002	.93	.50	.38	.68	.03
B14-516	100	18-14	5/16"		.93	.50	.38	.68	
B72	1,000	18-14	5/16"		.93	.50	.38	.68	
B14-38	100	18-14	3/8"		.96	.54	.35	.68	
B73	1,000	18-14	3/8"		.96	.54	.35	.68	
B14-12	100	18-14	1/2"		1.06	.72	.38	.70	
B75-TB	1,000	18-14	1/2"		1.06	.72	.38	.70	
B85	1,000	18-14	#6		.75	.31	.27	.59	
B134	1,000	18-14	#8		.72	.25	.27	.59	
C10-6-SK	50	12-10	#6		ERG2002	.82	.31	.27	
C33	500	12-10	#6	.82		.31	.27	.66	
C10-8-SK	50	12-10	#8	.82		.31	.27	.66	
C77	500	12-10	#8	.82		.31	.27	.66	
C10-10	50	12-10	#10	.85		.38	.27	.66	
C26	500	12-10	#10	.85		.38	.27	.66	
C36	500	12-10	#10	.82		.31	.27	.66	
C10-14	50	12-10	1/4"	.91		.50	.27	.66	
C71	500	12-10	1/4"	.91		.50	.27	.66	
C10-516	50	12-10	5/16"	.98		.50	.38	.73	
C70	500	12-10	5/16"	.98		.50	.38	.73	
C72	500	12-10	3/8"	1.10		.59	.45	.80	
C10-38	50	12-10	3/8"	1.10		.59	.45	.80	
C73	500	12-10	3/8"	1.10		.59	.45	.80	
C10-12	50	12-10	1/2"	1.21		.72	.38	.84	
C75	500	12-10	1/2"	1.21		.72	.38	.84	